

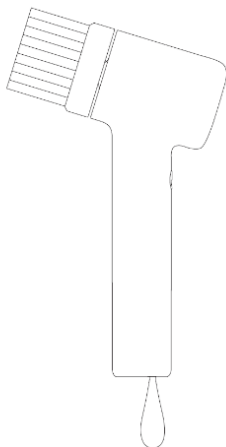

## RBX-B10/G 迷你電動清潔刷 USB Cleaning Brush



僅適用於家庭使用

For household use only

### 使用說明書

### OPERATION MANUAL

在使用本產品前，請仔細閱讀此說明書，閱讀後小心保存，以備日後查閱。

Please read the operation manual carefully before using and well keep it in a safe place for future reference.

本說明書中的圖示可能與實物有不同的地方，僅供參考。

Some figures in this manual may not match with the real object, just for reference only.

非常感謝您選購樂信牌 USB 電動清潔刷，在使用前請先詳細閱讀此說明書，並保存以備日後參考。

## 目錄

1. 安全注意事項
2. 保養、清潔及儲存
3. 產品規格
4. 產品結構
5. 配件的組裝與拆除
6. 使用方法
7. 充電方法
8. 故障排除
9. 特別聲明
10. 售後服務

# 1. 安全注意事項

使用本產品時，必須遵守下列安全預防措施：

## 1.1 使用前

1. 本產品包含不可更換電池，請使用配套的 USB 充電線充電。請將隨附的 USB 充電線插入直流 5 伏特 1 安培的 USB 充電器（本產品並不包括此配件）及插座，為產品充電。
2. 充滿電後指示燈轉為黃色，立即拔除 USB 充電器。長時間充電，可能造成充電池過熱或燃燒等危險。
3. 充電期間，切勿離開本產品。
4. 切勿使用有殘缺或鬆動的 USB 充電器。使用前確保 USB 充電器及充電線已充分抹乾及使用時插穩。
5. 切勿在 USB 充電器、充電線及產品上放重物或讓其接觸灼熱的表面；切勿夾住、改裝、用力拉扯或扭曲 USB 充電器、充電線及產品。
6. 切勿在 USB 充電線纏結的情況下為產品充電。
7.  此產品需要一個特定的獨立電源單元將本產品連接到電源。
8. 注意：為了給電池充電，只能使用本產品隨附的充電線。

## 1.2 使用中

1. 在插入或拔除 USB 充電器時，應手握穩 USB 充電插頭，不要抓住 USB 充電線。
2. 切勿讓小孩在沒有監督下使用、清潔及維修保養本產品或把其當作玩具。請將本產品及其充電器放於小孩及寵物不能接觸的地方。
3. 手濕時切勿組裝配件、接觸、插入或拔除 USB 充電線及 USB 充電插頭，否則可構成觸電的危險。

4. 為防止危險，必須按照此說明書建議方法使用，切勿在室外或用作清潔以外的其他用途。
5. 為避免危險，充電時必須遠離以下地方：
  - 易燃物、噴霧劑及煙劑等周圍
  - 熱源（如散熱器）、火源或直接受陽光照射的地方
  - 近水的環境
  - 大量熱氣、蒸氣或潮濕的地方
6. 本產品可供年齡在 8 歲或以上的兒童及體質、感覺或智力有障礙人士或缺乏經驗和相關知識的人士使用，但他們必須曾經接受負責安全人士的監督或指導如何安全地使用本產品和理解所涉及的危險。
7. 切勿擅自改裝本產品或使用非生產商提供的零件修理，否則可造成危險及維修保養無效。
8. 配合不同清洗需要，請選用合適的刷頭，避免損傷清洗物品。
9. 本產品可承受的溫度範圍為 0°C 至 40°C。

### 1.3 使用後

1. 經常檢查本產品及 USB 充電線。為避免危險，如有損壞請立即停止使用，並聯絡信興電器服務中心有限公司進行檢查及維修。
2. 使用完畢，請待主軸停止轉動，再取下配件。
3. 在清潔本產品、安裝或拆卸配件前，請確保 USB 充電線已從充電插座拔掉並確保<電源>已關閉。
4. 刷頭使用完後，需要用清水清洗乾淨，避免留污漬。
5. 切勿將本產品放置於書櫃、壁櫥或其他封閉的空間。確保本產品存放在通風良好的環境。

## 1.4 安全注意事項

1. 禁止拆解、撞擊、擠壓或將本產品投入火中。
2. 若本產品出現嚴重膨脹，請立即停止使用，並聯絡信興電器服務中心有限公司安排檢查及維修。
3. 切勿擅自改裝此產品或使用非生產商提供的零件進行修理，否則可造成危險及維修保養將會無效。

## 2. 保養、清潔及儲存

### 2.1 保養及儲存

1. 建議用戶定期清理刷頭，否則灰塵及污垢過度積聚，有可能會減弱產品的清潔效能。
2. 清潔前，必須確保產品已關閉、拆卸刷頭配件後才能進行清潔。
3. 不要用天拿水、汽油、去污粉、硬質刷及不鏽鋼絲球等來清潔配件，以免刮花或腐蝕部件表面，致產生異味或滋生細菌。
4. 如長期不使用本產品，請拔掉 USB 充電線，並於清潔後，套上塑膠袋，藏於乾爽及避免紫外光直接照射的環境。

## 2.2 清潔刷頭

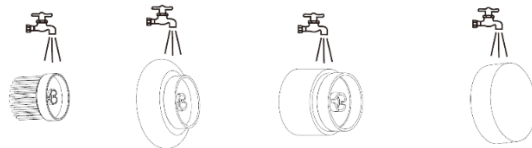

- 如刷頭的主軸被毛髮或異物纏繞，可試著用鑷子協助去除；可加入適量清潔劑在刷頭上，用水清洗乾淨，再用水沖洗刷頭殘留的清潔劑。

## 2.3 清潔機身

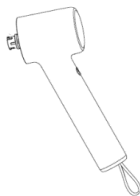

- 切勿用水直接沖洗主機。使用柔軟濕布擦拭主機表面。若表面污漬太多，可用沾有少量溫和清潔劑的軟布擦拭，然後以濕布過淨。
- 主機清理乾淨後，機身掛繩可以掛在廚房勾架以便使用。

### 3. 產品規格

型號	RBX-B10/G
額定電壓	直流3.7伏特
額定功率	10 瓦
充電池種類	鋰離子電池
輸入電壓/電流	直流 5 伏特 1 安培
額定充電池容量	1,500 毫安時
充電時間 (約)	3.5 小時
使用時間 (約)	約 1 小時*
轉速(約)	轉速 1 : 160 轉/分鐘 轉速 2 : 200 轉/分鐘
產品尺寸 (闊 x 深 x 高) (約)	53.5 x 128 x 249 毫米
淨重 (約)	0.35 公斤

\* 本產品可運行時間的長短會因充電池溫度及其他使用條件而有所差異。

## 4. 產品結構

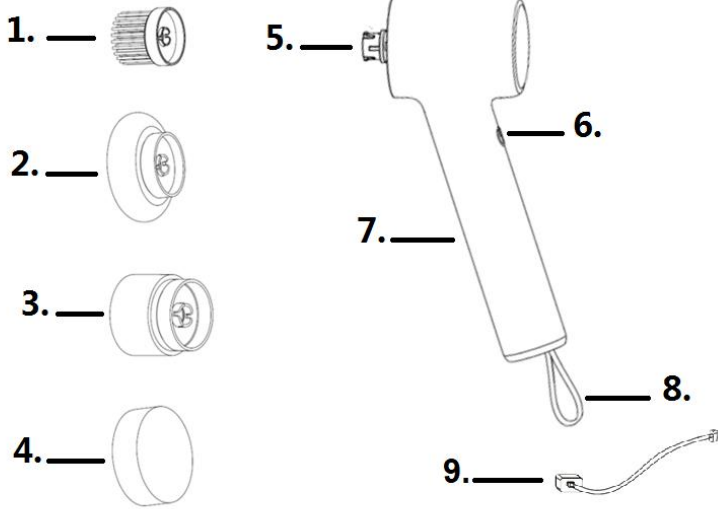

- |          |                    |
|----------|--------------------|
| 1. 軟毛刷頭  | 6. 電源開關            |
| 2. 鋼絲球刷頭 | 7. 主機              |
| 3. 細海綿刷頭 | 8. 掛繩              |
| 4. 粗海綿刷頭 | 9. 充電線 (micro-USB) |
| 5. 主軸    |                    |



## 5. 配件的組裝與拆除

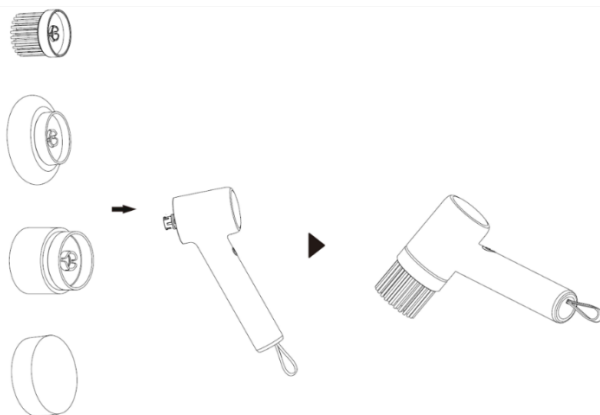

1. 將刷頭的中心對準主機的主軸位置，將刷頭輕輕按向主軸，直至刷頭與主軸完全貼合。
2. 拆除刷頭時，手握刷頭，向前拔出。
3. 使用者可根據實際使用情況採用合適的刷頭使用。

### 注意！

- 組裝時須分外小心，慎防接合位置夾傷手指；確保所有連接部件已安裝穩妥，以防使用過程中脫落。
- 組裝時，產品須為關機狀態。

## 6. 使用方法

### 6.1 各清潔刷頭的使用

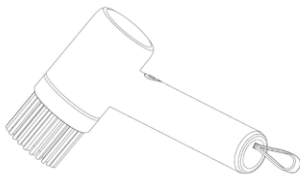

- **軟毛刷頭：** 瓷磚、大理石、地板、灶台、金屬面、鞋面、木質傢俱清潔。

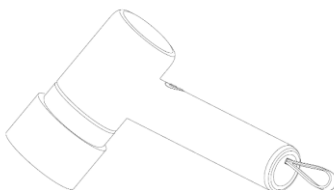

- **細海綿刷頭：** 餐具、窗戶玻璃、鏡面、亞克力等表面清潔。

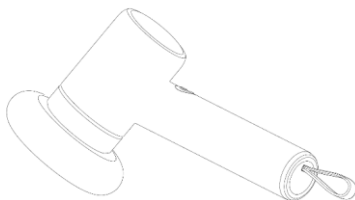

- **鋼絲球刷頭：** 燒烤架、無塗層不鏽鋼炒鍋、不鏽鋼水槽、不鏽鋼置物架等重污垢的地方。

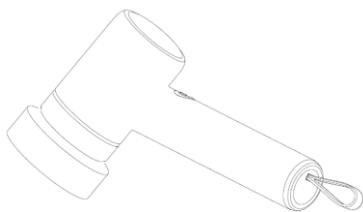

- **粗海綿刷頭：** 廚房、抽油煙機、水槽、瓷磚等有油煙污垢的地方。

### 注意！

- 面對難以清除的污漬，用戶可加入稀釋的中性清潔劑；正確使用清潔劑，並嚴格遵照比例使用。

## 6.2 操作本產品

用戶先按“**章節 5. 配件的組裝與拆除**”將刷頭及主機組裝，然後弄濕刷頭，並按以下內容操作本產品：

1. 啟動本產品：雙擊<電源>鍵，黃色指示燈常亮，產品開始運作。刷頭開始旋轉時，可將產品放置於需要清理的表面上清潔。
2. 一般情況下，利用刷頭上下前後拖動，不須費勁。而需要時，可再按一下<電源>鍵，紅色指示燈常亮，產品進入第二段清潔模式，輔助清洗。
3. 關閉本產品：完成清潔後，按一下<電源>鍵，刷頭停止旋轉並關機。

## 注意！

- 切勿過度按壓刷頭，以免造成損毀。
- 完成後，如長時間未有關閉電源，有可能會引起故障。
- 切勿用手接觸正在旋轉的刷頭，有可能會造成損傷。
- 產品必須於組裝刷頭的情況下使用；而運作過程中，容易造成損毀、掉落、纏繞刷頭或勾住刷頭的物件（如：麻繩或地毯等物件）須遠離本產品。

## 7. 充電方法

首次使用，或者長時間不使用時，必須確保產品已完成充電。(切勿於充電時開啟本產品)

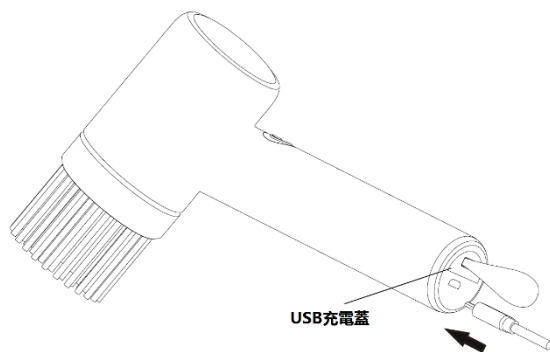

- 產品必須拆除配件後再進行充電。
- 請使用直流電 5 伏特 1 安培或 1 安培以下的 USB 充電插頭 ( 本產品沒有配備 USB 充電器插頭 ) 給本產品充電，充電過程中紅色指示燈常亮。充滿電後，變為黃色指示燈常亮。
- 產品充電時，不能啟動運作。

### 注意！

- 首次使用前，必須將電池徹底充電。
- 若長時間不使用本產品，請每三個月進行一次充電，防止電池老化。

## 8. 故障排除

<u>故障現象</u>	<u>原因</u>	<u>解決方法</u>
產品不能運作。	檢查是否已開啟開關。	雙擊<電源>鍵。
	檢查主軸或刷頭是否被異物纏繞。	參考“ <b>章節 2. 保養、清潔及儲存</b> ” 清理主軸或刷頭上的異物。
產品<電源>鍵閃爍紅燈。	主機電量不足。	重新將產品充電。
產品在工作時沒有按功能運作，出現失靈現象。	產品內部有水。	檢查產品的 USB 充電蓋是否密封好，產品放置乾燥處，等內部水自然風乾後再啟動運作。

\*如使用以上方法仍未能使產品恢復正常操作，切勿嘗試自行維修。請聯絡信興電器服務中心有限公司進行檢查及維修。

## 9. 特別聲明

1. 本資料上所有內容經過核對，如有任何印刷及內容上的誤解，本公司將保留解釋權。
2. 本產品若有技術改進，會編進新版說明書中，恕不另行通知；產品外觀、規格如有改動，則以製造商資料為準。
3. 如本資料之中英文版本有差異時，應以中文版為準。
4. 使用說明書的電子副本可以通過電子郵件發送致客戶，如有需要，可致電信興電工工程有限公司：2861 2767。

## 10. 售後服務

1. 由購買收據日期起之一年保修期內，經信興電器服務中心有限公司之服務人員證實產品故障屬於正常使用之情況下發生者，本公司將提供免費維修或更換零件服務。經更換之任何損壞零件，將歸屬本公司所有。保修範圍不包括修理或更換產品之損耗性零件等。
2. 用戶必須於維修時出示購買收據/換購收據及蓋有銷售點/換購中心印章的產品保修記錄卡。如有任何疑問，請致電信興電器服務中心有限公司熱線：2406 5666查詢。

Thank you for choosing Rasonic USB Cleaning Brush. Read the operation manual carefully before use and keep it for your future reference.

## **Table of Contents**

1. Important Safeguards
2. Maintenance, Cleaning and Storage
3. Product Specifications
4. Product Descriptions
5. Accessories Assembly and Disassembly
6. Operation Instructions
7. Charging
8. Troubleshooting
9. Special Avowal
10. After Sales Service



# 1. Important Safeguards

When using the appliance, please follow below safety precautions:

## 1.1 Before the first use

1. This appliance contains batteries that are non-replaceable. Please use the provided USB charging cable to charge the appliance. Please insert the provided USB charging cable to DC5V 1A adapter (not supplied with the appliance) and power socket to charge the appliance.
2. When fully charged, the indicator light turns to yellow. Make sure to remove the USB adapter after fully charged. Charging for a long time may cause hazards

such as rechargeable battery overheats and burn.

3. Do not leave the appliance unattended while it is charging.
4. Never use deficient or loosen USB adapter. Make sure the USB charger and charging cable are dry before use and inserted firmly when use.
5. Do not put heavy objects on the charger cable, USB adaptor and appliance or let it touch any hot surface.  
Never clip, modify, stretch or twist the USB charger, USB charging cable and appliance.
6. Do not use the USB charging cable when it is tangle.
7.  A specific separated power supply unit is required to connect this appliance to power supply.

8. **WARNING:** For the purpose of recharging the battery, only use the USB charging cable that provided with this appliance.

## 1.2 When using the appliance

- 1 Always hold the USB adaptor tightly with hands when insert or remove it. Do not grasp USB charging cable.
- 2 Children shall not play with the appliance. Using, cleaning and maintenance shall not be made by children without supervision. Put the appliance and its USB charging cable in a place not reachable by children or pet.
- 3 Never assemble accessories, touch plug or unplug the

USB charging cable and USB adapter with wet hands, otherwise it may cause electric shock.

- 4 To avoid danger, use the appliance only as described in the manual. Do not use outdoors or for other purposes than cleaning.
- 5 To avoid danger, never charge the appliance near the environment of:
  - Flammable materials, sprays and aerosols
  - Heat source (e.g. radiator), fire or expose under direct sunlight
  - Near water
  - Massive hot air, steam or humid area
- 6 The appliance can be used by children aged from 8

years and above and person with reduced physical, sensory or mental capabilities, or lack of experience and knowledge, if they have been given supervision or instruction concerning use of the appliance in a safe way and understand the hazards involved.

- 7 Do not attempt to modify the appliance by yourself or repair with any parts that are unauthorized, otherwise it may cause hazards and warranty becomes invalid.
- 8 In different cleaning scenarios, please choose the appropriate brush head to avoid damage to the cleaning items.

- 9 The appliance can withstand a temperature range of 0-40°C.

### **1.3 After using the appliance**

- 1 Always check the condition of the appliance and USB charging cable. To avoid hazards, please stop using it immediately if any damage is found. Please contact Shun Hing Electric Service Centre Limited for checking and repairing.
- 2 After using, wait for the spindle stops rotating, remove the detachable accessories.

- 3 Remove the USB charging cable from USB adapter and keep the main body off the power before cleaning appliance, installing or removing the accessories.
- 4 After using the brush head, you need to clean it with clean water to avoid leaving stains.
- 5 Do not place the appliance in a bookcase, built-in cabinet or in another confined space. Make sure this appliance stored in a well-ventilated environment.

## **1.4 Beware of the following**

- 1 Do not disassemble, impact, crush or throw this appliance into fire.

- 2 If the appliance has severe swelling, please stop using it immediately and contact Shun Hing Electric Service Centre Limited for checking and repairing.
- 3 Do not attempt to modify the appliance by yourself or repair with any unauthorized parts, otherwise it will cause hazards and warranty will become invalid.



## 2. Maintenance, Cleaning and Storage

### 2.1 Maintenance and Storage

- 1 It is recommended to clean the brush head regularly, otherwise if too much dusts accumulated, it may weaken the cleaning performance of the appliance.
- 2 Make sure the appliance is off, remove the brush head and cleaning the appliance.

- 3 Do not use lacquer thinner, gasoline, decontamination powder, hard brush or metal brush to clean the accessories, so as to avoid scratching and corroding the surface of the parts, resulting in odor or breeding of bacteria.
- 4 If you do not use this appliance for a long time, please unplug the USB charging cable, put it in a plastic bag after cleaning, and store it in a dry place and avoid direct ultraviolet light.

## 2.2 Cleaning Brush

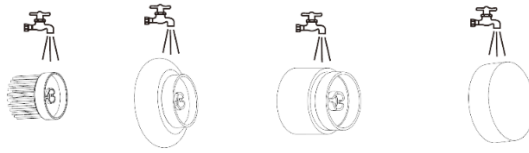

- When the spindle gets stuck by foreign objects, use tweezers to help clean the objects; Each brush head can add an appropriate amount of detergent on the brush, wash it with water, and then rinse the residual detergent on the brush with water.

## 2.3 Cleaning the main body

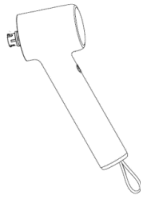

- Do not rinse the main body with water. Use a damp cloth to clean its surface. If it is too dirty, wipe it with a damp cloth with a little mild detergent, then wipe with damp cloth.
- After the main body is cleaned, the hand strap can be hung on the kitchen hook for use.

### 3. Product Specifications

<b>Model</b>	RBX-B10/G
<b>Rated Voltage</b>	DC 3.7 V
<b>Rated Power</b>	10W
<b>Rechargeable Battery Type</b>	Lithium-ion rechargeable battery
<b>Input Voltage / Current</b>	DC 5 V / 1A
<b>Rated Rechargeable Battery Capacity</b>	1,500 mAh
<b>Charging Time (Approx.)</b>	3.5 hrs
<b>Operation Time (Approx.)</b>	1 hour*
<b>Rotation Speed(Approx.)</b>	Mode 1: 160rpm Mode 2: 200rpm
<b>Product Size (WxDxH) (Approx.)</b>	53.5 x 128 x 249 mm
<b>Net Weight (Approx.)</b>	0.35 kg

\* The length of operation time can be varied depending on the temperature of the battery and other usage conditions.

## 4. Product Descriptions

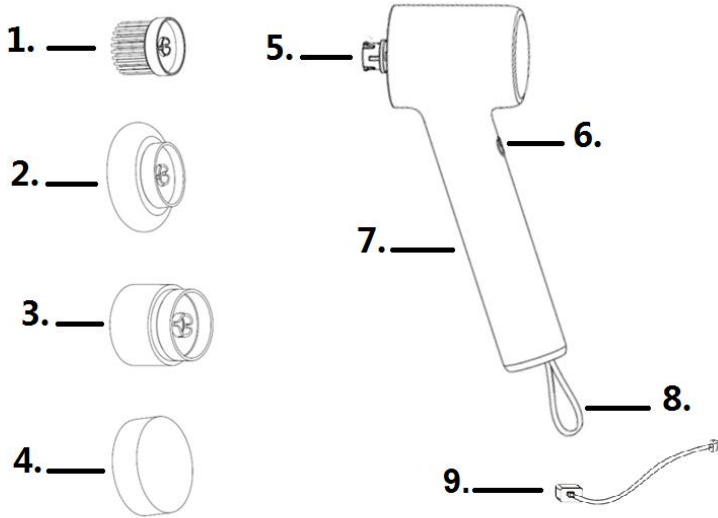

- |                             |                               |
|-----------------------------|-------------------------------|
| 1. Soft hair brush head     | 6. Power button               |
| 2. Wire brush head          | 7. The main body              |
| 3. Sponge brush head        | 8. Hang strap                 |
| 4. Coarse sponge brush head | 9. Charging cable (micro-USB) |
| 5. Spindle                  |                               |

## 5. Accessories Assembly and Disassembly

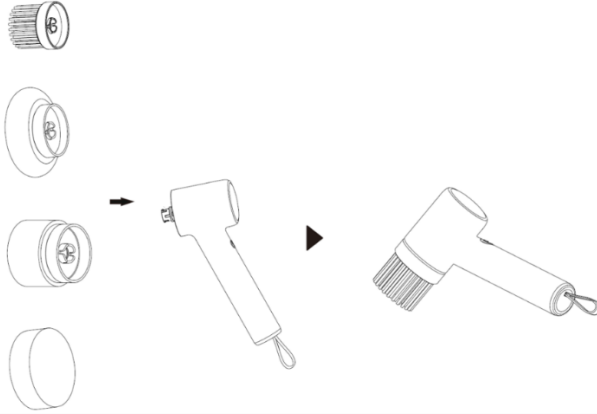

1. Align the center of brush head with the center of the spindle, press the brush head down to attach.
2. When removing the brush head, hold the brush head firmly with hands, pull out from the front.
3. End-user can use the appropriate brush head according to the actual use.

### CAUTION!

- Pay attention during assembly, be careful not to pinch your finger at the joint, and make sure all the components are well-installed to avoid accessories falling off when used.
- When assembly, make sure the appliance is Off.

## 6. Operation Instructions

### 6.1 Use of each cleaning brush head

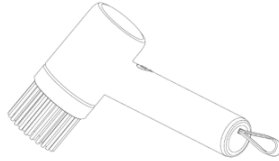

- **Soft hair brush head:** clean tiles, marble, floors, cooktops, metal surfaces, shoe uppers, wood furniture.

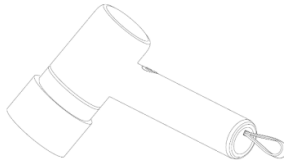

- **Sponge brush head:** clean tableware, window glass, mirror, acrylic and other surfaces.

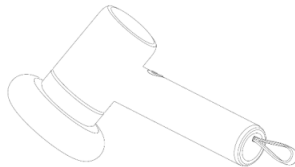

- **Wire brush head:** barbecue grills, uncoated stainless steel wok pans, stainless steel sinks, stainless steel shelves and other places with heavy dirt.



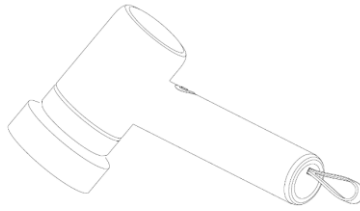

- **Coarse sponge brush head:** kitchens, range hood, sinks, tiles and other places with soot and dirt.

## **CAUTION!**

- To deal with stain which is difficult to remove, use the detergent correctly and strictly follow the water and detergent ratio recommended.

## **6.2 Instruction of use**

According to “**Chapter 5. Accessories Assembly and Disassembly**” , assemble the cleaning brush head and the main body accordingly. Moisten the brush, and then operate the appliance as follow:

1. Start the operation: double click the <power button>, yellow indicator light on, the appliance start operation. Place the rotating brush head on the surface which need to clean.
2. In normal situations, you need not to add force when cleaning; if necessary, press the yellow <power button>, red indicator light on, the appliance will turn to faster mode, helping to clean the surface.
3. End the operation: once finished cleaning, press the <power button> once to off the operation.

## CAUTION!

- Do not press the brush head excessively to avoid damage the appliance.
- After operation, if the <power button> is not pressed OFF for a long time, the appliance will malfunction.
- Do not touch the rotating cleaning brush head; otherwise, you may be injured.
- The appliance must be used with assembled cleaning brush head; during operation, objects that are likely to be damaged, falling, or entangled/ hooked by the cleaning brush head (such as hemp rope or carpet, etc.) must be kept away from the appliance.

## 7. Charging

Be sure to fully charge the battery before first use or when not used for a long time. (**DO NOT** operate the appliance when charging)

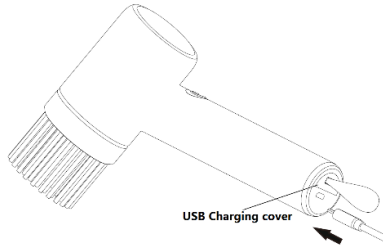

- Detach all accessories before charging.
- Please connect this appliance to power supplier DC5V 1A or below 1A (this appliance is not equipped with an USB adapter) to charge this appliance. During the charging process, the indicator light turns to red. When fully charged, the indicator light turns to yellow.
- When the appliance is charging, it cannot start to operation.

### CAUTION!

- Make sure to fully charge the appliance before the first time of use.
- If the appliance is not used for a long time, charge it every 3 months to prevent battery aging.

## 8. Troubleshooting

Problem	Reason	Solution
The appliance does not work.	Check if the power button is on.	Double click the <power button>.
	Check if the spindle or brush get stuck by foreign objects.	Refer to “ <b>Chapter 2 Maintenance, Cleaning and Storage</b> ” to clean the foreign objects on spindle or brush head.
The <power button>indicator flash red light.	Battery drained.	Use it after charging.
The appliance does not operate according to its function during work, and malfunction occurs.	Water penetrated to the inner appliance.	Check the USB charging cover of the appliance is sealed well, place the appliance in a dry place, and wait for the internal water to dry naturally before starting operation.

If the above solutions cannot fix the problem, do not attempt to modify the appliance by yourself and please contact Shun Hing Electric Service Centre Ltd. to check and repair.

## 9. Special Avowal

1. The content in the operation manual has been checked. Our company reserves the hermeneutic power to any printing errors or misunderstanding on the content.
2. If there are technical improvements on the appliance, the operation manual will be updated in new version without prior notice. The product appearance and specification are subject to the manufacturer information.
3. In case there is any inconsistency or conflict between the English versions and Chinese versions of the terms, the Chinese versions shall prevail.
4. The e-copy of user manual can be sent by email on requested. For enquiries, please call Shun Hing Electric Works & Engineering Co., Ltd. hotline at 2861 2767.

## 10. After Sales Service

1. For any defect, in the judgement of technician from Shun Hing Electric Service Center Limited, caused under normal use, our company is responsible for repairing or replacing parts of the said electrical appliance free of charge within one year guarantee period commencing from the date of purchase. Any defect part which has been replaced shall become our property. Guarantee service does not cover the repair or replacement of consumable parts etc.
2. User must present the official invoice/redemption voucher and the product warranty card with the chop from sales point/redemption center for maintenance. For enquiries, please call Shun Hing Electric Service Center Limited hotline at 2406 5666.

# 備忘錄

---

# 備忘錄

---



# 備忘錄

---



**Rasonic 樂信牌**

信興電工工程有限公司

SHUN HING ELECTRIC WORKS AND ENGINEERING CO., LTD.

辦公室：香港九龍尖沙咀東部麼地道67號半島中心9樓

電話：2861 2767

圖文傳真：2865 6706

網址：<http://www.rasonic.com>

電郵：shew@shunhinggroup.com

Office: 9/F, Peninsula Centre, 67 Mody Road, Tsimshatsui East, Kowloon, H.K.

Tel: 2861 2767

Fax: 2865 6706

Website: <http://www.rasonic.com>

E-mail: shew@shunhinggroup.com

保養及維修 Maintenance and Repair Service:

信興電器服務中心有限公司

SHUN HING ELECTRIC SERVICE CENTRE LTD.

香港新界葵涌勝耀街2號信興中心11樓

電話：2406 5666

圖文傳真：2408 0316

網址：<http://www.shesc.com/zh>

11/F, Shun Hing Centre, 2 Shing Yiu Street, Kwai Chung, N.T. H.K.

Tel: 2406 5666

Fax: 2408 0316

Website: <http://www.shesc.com/en>

客戶服務中心

香港新界葵涌勝耀街2號信興中心1樓

九龍尖沙咀東部麼地道67號半島中心B座9樓

香港天后琉璃街7號柏景中心22樓

澳門慕拉士大馬路193-199號南嶺工業大廈5樓1座

Customer Service Centre

1/F, Shun Hing Centre, 2 Shing Yiu Street, Kwai Chung, N.T.

9/F, Block B, Peninsula Centre, 67 Mody Road, Tsim Sha Tsui East, Kowloon

22/F, Parkview Centre, 7 Lau Li Street, Tin Hau, Hong Kong

Avenida de Venceslau de Morais, No. 193-199, 5 andar - 1, Edf. Industrial Nam Leng, Macau

有關最新之香港及澳門客戶服務中心資料，請參閱信興服務中心網址：<http://www.shesc.com/zh>

For the latest information of Hong Kong and Macau service center, please visit <http://www.shesc.com/en>

RBX-B1222